

STAIR TREAD VISUALLY IMPAIRED RUBBER INSERT & GRIT TAPE REPLACEMENT TIP SHEET

INTRODUCTION

These instructions are written as a guide to be used by professional installers in the replacement of inserts and tapes in Tarkett Visually Impaired stair treads. This is not intended to replace our installation instructions or train a flooring installer on the process of heat welding. Always visit www.tarkettna.com for the most current installation and maintenance instructions. Technical videos and tip sheets are also available. Contact Tarkett Technical Services at (800)-899-8916 with any questions.

These instructions apply to Rubber stair treads produced after 8/13/2021.

TOOL LIST

- 2" Tarkett Powertape
- Knife
- Cut Resistant Gloves
- Metal Scraper or Chisel
- Heat Gun
- Tape Measure
- Hand roller
- Replacement Insert or Tape
- Clean White Rag
- Denatured Alcohol or Methyl Hydrate (Follow manufacturer's precautions when using denatured alcohol.)

REPLACEMENT PROCEDURE

RUBBER INSERT

1. Using a knife, cut the Rubber Insert in half near the middle of the stair tread, cutting from back to front. Care must be taken not to cut past the depth of the channel or into the tread. Only cut the insert, do not cut too deeply.



2. Starting at the cut in the strip using a metal scraper or chisel, lift the insert off of the tread and pull the Rubber Insert towards the stringer and away from the tread. Repeat the process for the other half of the strip.



3. Remove all adhesive tape residue from the channel. Use a heat gun to soften the tape and scrape with a metal scraper or chisel. Denatured alcohol can be liberally applied to the channel to assist in the removal of the tape residue after scraping. (Follow manufacturer's precautions when using denatured alcohol.) **NOTE: The adhesive residue must be completely removed prior to installation of the new Rubber Insert.**



4. Cut the new Rubber Insert to match the length of the stair tread.

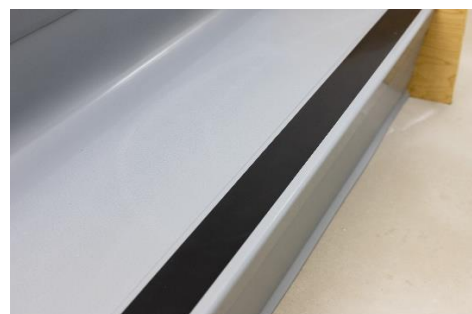

5. Cut a length of the 2" Tarkett PowerTape™ to match the length of the stair tread. Adhere it into the channel. Roll the tape with a hand roller to ensure bond.



6. Remove the release liner from the PowerTape. Place the insert into the channel by starting at one side and working towards the opposite. Take care not to stretch the insert while placing it into the channel.

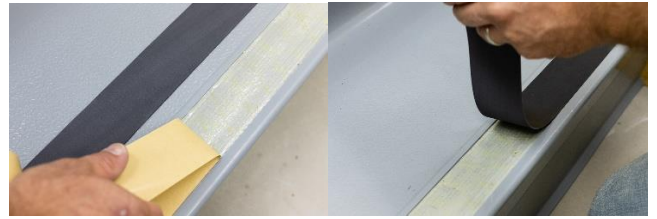

7. Roll the Rubber Insert with a hand roller.

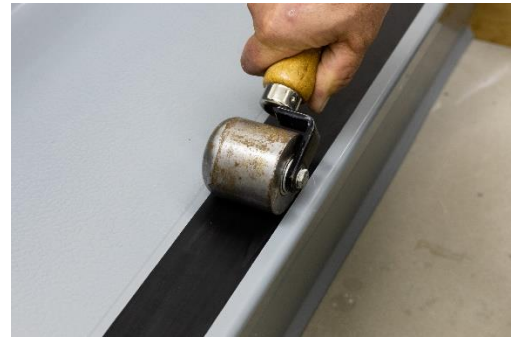

GRIT OR PHOTOLUMINESCENT TAPE

1. Starting at the stringer, remove worn out tape from stair tread channel by peeling or scraping with a metal scraper or chisel.

PHOTOLUMINESCENT TAPE



GRIT TAPE



2. Remove all adhesive tape residue from the channel. Use a heat gun to soften the tape and scrape with a metal scraper or chisel. Denatured alcohol can be liberally applied to the channel to assist in the removal of the tape residue after scraping. (Follow manufacturer's precautions when using denatured alcohol.) **NOTE: The adhesive residue must be completely removed prior to installation of the new grit or Photoluminescent tape.**



3. Cut new grit or Photoluminescent tape. Keep the grit or Photoluminescent tape back 1/16" from the stringer on both sides of the stair tread.



4. Cut a length of the 2" Tarkett PowerTape to match the length of the new grit or Photoluminescent tape. Adhere it into the channel. Roll the tape with a hand roller to ensure bond.



5. Remove the release liner from the remaining side of the PowerTape as well as from the back of the grit or Photoluminescent tape. Place the grit or Photoluminescent tape into the channel by starting at one side and working towards the opposite, ensuring that the 1/16" gap is equally maintained at both stringers.

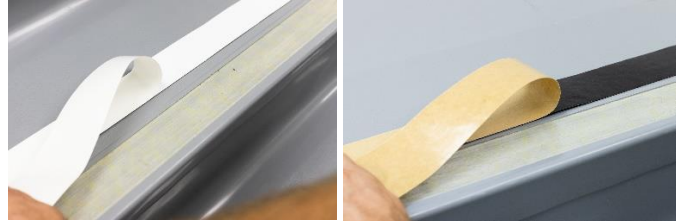

6. Roll the grit tape or Photoluminescent tape with a hand roller.

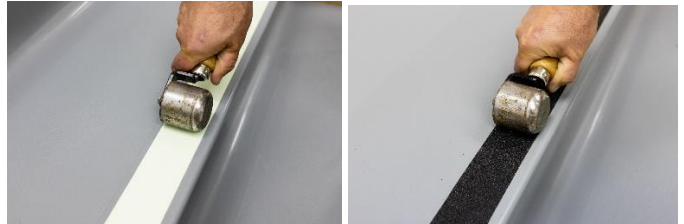

Tarkett North America

Technical Services Department
30000 Aurora Road
Solon, OH 44139
800.899.8916 Fax 440.632.5643
info@tarkettna.com

www.tarkettna.com