

# iQ, Premium, Plus

Homogeneous vinyl tiles

October 2014

## CONDITIONS AND REQUIREMENTS

- The subfloor must be clean, dry and free from cracks. Dust and contaminants that could prevent adhesion, such as patches of paint, oil, etc., must be removed. Note that asphalt, oil spillage, impregnation agents, pen marks, etc., can cause discoloration.
- Damp proofing to be carried out according to local building standards. Where required an effective damp proof membrane must be incorporated in the subfloor. Check for dampness in ground supported floors, floors above boiler rooms, floors with underfloor heating or containing high temperature pipework etc.
- **When installing this product on concrete subfloors that do not include damp-proofing, the moisture content measured in terms of relative humidity must not be higher than 85% (in UK and Ireland 75% according to BS 8203). Or less than 2% with CM (Carbide Method).**
- Where pipes are laid in the floor they should be arranged so that the flooring material is not continuously subjected to a temperature above 27°C, otherwise there may be discoloration and/or other alterations of the material.
- Extra special care must be taken regarding installations on surfaces where significant temperature changes can be expected, for example, floors exposed to strong sunlight, as adhesion strength and subfloor treatment may be heavily stressed.
- Floor boards and similar substrates should have a moisture content of max 8% (equivalent to 40% RH at +20°C), so that any subsequent movements cannot cause damage.

## PREPARATION

- Dust and loose particles must be thoroughly removed. Highly absorbent or variably absorbent substrates should be sealed with suitable primer. The primed surface must be completely dry before laying commences.
- When applying smoothing compounds, use compounds that meet the minimum requirements in the building standards. NOTE: Discolouration can occur when using two-parts polyester compounds if they are mixed incorrectly and/or insufficiently. Do not mix directly on the substrate.
- Use only a lead pencil for marking. Note that any marks made with felt-tipped pens, permanent and non permanent ink markers, ball point pens etc. can cause discoloration due to migration.

## STORAGE

- Tarkett's general recommendation is to store material indoors in normal room-temperature, which means approximately 18°-26°C. **Pallets of tiles are not allowed to be placed and stored upon each other.**

## CONDITIONS ON SITE

- Prior to laying, allow the boxes of tiles, adhesive and subfloor to reach room temperature for 48 hours. I.e. a temperature of at least 18°C. **Conditioning areas and laying areas must be of similar temperature, to prevent dimensional changes.** The relative air humidity should be 30-60%. **Make sure the boxes of tiles are piled not more than five, flat and parallel.**

## INSTALLATION

- Installation should be carried out at room temperature between 18°C to 26°C. Subfloor temperature must be at least 15°C. The relative air humidity in the premises should be 30-60%. Maintain same temperature and humidity for at least 72 hours after installation.
- **If material from several boxes is used, they should have the same manufacturing serial numbers and be used in consecutive order. Boxes from different pallets must not be mixed. Pallets shall be installed in sequence.**
- **The tiles are fully adhered with an adhesive approved by the manufacturer for installation of homogeneous vinyl tiles.**
- The assembly time depends on the type of substrate, its absorbency, the temperature and air humidity in the premises. See the adhesive manufacturer's instruction regarding coverage, open time etc.
- Pressure sensitive adhesives can immediately be rolled with a lambs wool roller to remove the risk of a trowel applied adhesive mirroring. The lambs wool roller should be continually resaturated in adhesive directly from the adhesive tub to prevent the original trowel applied adhesive from being poorly dispersed over the subfloor.
- Tiles can be installed in the same direction or in a checkerboard pattern.

*If any doubts or clarifications should be needed, please contact your local Tarkett representative for further information.*

## INSTALLATION

- Before starting installation, determine the method of laying taking into account the shape of the room and the design to be laid. Installation should start from the middle of the room and be finish along the walls.
- Install the tiles tight edge to edge. Tiles must be firmly pressed together.

- Ensure that the tiles make good contact with the adhesive and that all air is expelled. Use a floor roller (approx. 65 kg) and roll crosswise over the floor. Re-roll after 30-40 minutes.
- The tiles are recommended to be hot welded with approved welding rod.
- iQ Optima Essence Decorplanks shall not be welded.

## WELDING

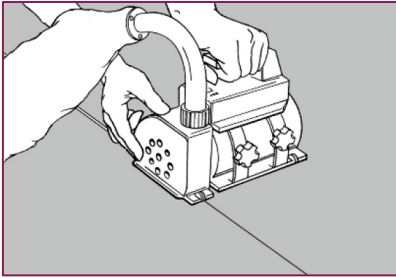

The tiles are heat welded. Do not weld until the adhesive has bonded completely. The joints are chamfered or grooved to about  $\frac{3}{4}$  of the thickness using a hand grooving tool or machine prior to welding.

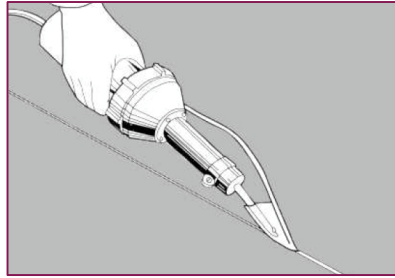

Weld with hot-air and Tarkett Speed Welding Nozzle. Carry out a test welding on a left-over piece before commencing work, to adjust speed and temperature  
**IMPORTANT:** When welding iQ Megalit, a Tarkett Speed Welding Nozzle or equivalent should be used.

## TRIMMING

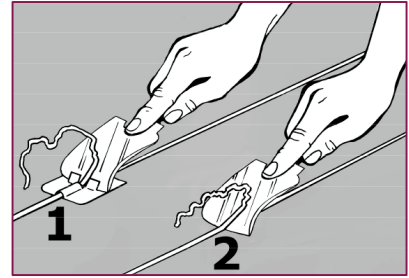

CAUTION: Welded seams must cool to room temperature before trimming. Start trimming where you began welding. All trimming of welding thread is recommended in two steps: rough and fine trimming.

## INSPECTION

- The work must be completed with an inspection. Ensure that the newly laid flooring is free from adhesive residues and that the bond is consistent with no bubbles.
- **Always protect the floor with thick paper, hard board or similar during the construction period.**

## GENERAL

- This information is subject to change due to continuous improvement.

## FOR THE BEST RESULTS

- Make sure all specifications and instructions are followed carefully.
- Use only adhesives recommended by adhesive manufacturer.
- Contact your Tarkett representative if unsure about any part of the installation.

*If any doubts or clarifications should be needed, please contact your local Tarkett representative for further information.*