

## iD Click Ultimate Starfloor Click Ultimate

LUKSUSLIKUD VINÜÜLPLAADID

### A- PAIGALDUSVAHENDID

- Sirge teraga nuga
- Kaitsekindad
- Valge peaga kummivasar
- Tollipulk/möötelint
- Pliats/ rõõpjoonlaud
- Vahepuksid
- Vineerisaag

### B- PAIGALDUSEELNE ETTEVALMISTUS JA OLULINE INFO

#### B.1 KAUBA ÜLEVAATUS

Kontrollige tarnitud kauba kvaliteeti enne ettevalmistustööga alustamist. Pretensioone ei saa esitada kauba suhtes, mis on juba mõõtu lõigatud või paigaldatud. Tagamaks disaini ja värvi ühtsust tuleb paigaldamiseks kasutada sama tootepartiid.

#### B.2 AKLIMATISEERIMINE

iD Click Ultimate / Starfloor Click Ultimate vajab vähemalt 24-tunnist aklimatiseerumist ruumis, kuhu see paigaldatakse vastavalt allpool toodud üksikasjalikele tingimustele.

#### B.3 RUUMI TEMPERatuur

iD Click Ultimate / Starfloor Click Ultimate paigaldatakse ruumi temperatuuril 10° C kuni 30° C. Aluspõranda temperatuur ei tohi olla alla 10° C.

#### B.4 ALUSPÕRANDA SEISUND

Valmistage pind ette vastavalt teie riigis kehtivatele standarditele. Põranda pind peab olema loodis, tugev ja niiskuskindel. Vaadake allpool toodud aluspõrandaid. Maksimalne tasapinnalisuse tolerants on 3 mm 2 jooksva meetri kohta. Tekstiilist ja nõelvildist põrandakatted tuleb eemaldada. Üldiselt soovitatakse eemaldada igasugused põrandakatted.

Meie soovitame iD Click Ultimate / Starfloor Click Ultimate mitte paigaldada, kui:

- Olulised ebaühtlased kohad (mis ületavad vastavates riikides kehtivaid tasasuse norme),
- Praod aluspõrandas,
- Aluspõrand ei ole piisavalt kuiv,
- Pinnas ei ole piisavalt kõva või on liiga poorne või tahumata,
- Reostunud pinnas, näiteks õli, vaha, laki või värvijäägi tulemusel,
- Tasapindade erinevus aluspõranda ja muude struktuurielementide vahel,
- Aluspõranda sobimatu temperatuur (alla 10°C),
- Alla 10°C või üle 30°C toatemperatuur, kütteprotokolli puudumine.
- Põrandakütte puhul ei ole kütteprotokoll vajalik (kogu eluaja jooksul maksimumtemperatuurini 27°C).

### LUBATAVAD ALUSPÕRANDAD

- Altpoolt ventileeritavad laminaat/parkettpõrandad, Even stone floors, marble, ashlar
- Tasased kivi-, marmor-, kantkivirpõrandad,
- Keraamilised plaadid (nõuded plaadi vahedele < 8 mm lai/< 3 mm sügav)
- Kompaktsed PVC katted
- Ebatasase põranda tasanduskihid: uued või parandatud.
- Toode kaotab garantii kui seda on kasutatud aluspõrandal, mis ei ole heakskiitu saanud.

## C- PAIGALDUS

### C.1 Paigalduse suund

Always start the installation from left to right. In a room, install the panels so that the planks are in the direction of the light.

In long, narrow rooms, such as corridors, iD Click Ultimate can be installed in the direction of the room.

### C.2 INSTALLATION

Using a suitable spacer, create an expansion joint at least 6 mm wide along the entire periphery. TIP: Use flooring offcuts as spacers. Also maintain a gap of 6 mm from all fixtures in the room, such as pipes, door frames etc. In principle, this expansion joint must not be filled with silicone, electric cables or other items.

### C.3 THE USE OF SILICONE IS PERMITTED IN THE FOLLOWING EXCEPTIONAL CASES:

#### • Damp rooms:

Edge joints in damp rooms of max. 10 m<sup>2</sup>, e.g. bathrooms or kitchens, may be made with silicone in order to avoid any infiltration of water through the expansion joint and onto the installed surface. For all larger areas in damp rooms, we recommend starting by applying insulating tape to the area of the joint before filling it with a quantity of silicone and/or using a skirting board with a sealing lip.

#### • Door frames:

If the door frames cannot be shortened, we recommend a 3 mm gap for the expansion joint, which can be filled with silicone. If the frames can be shortened, make sure that there is a 6 mm expansion joint in relation to the wall.

### C.4 INSTALLATION

Install the first panel with the tongue side facing the wall, then install all the other panels in the same from left to right. Make sure that the ends are placed one on top of the other so that the grooves and the tongues correspond exactly and lock them by tapping lightly with a rubber mallet. To install the next row, place the left-over panel of at least 30 cm in length into the longitudinal groove of the row already installed at an angle of approximately 30° and lower it into the previous row using slight pressure. Take the next panel, place it also at an angle of approximately 30° in the longitudinal direction on the panel of the first row already installed, align it as closely as possible with the end of the panel previously installed and lock it as described above. This method is then used to install all of the other rows. Make sure that the end joints are offset by at least 30 cm in the individual rows in order to achieve the best installation. To install the last row, the distance between the wall and the row installed is measured and transferred to the panel. The last row installed should be as close to half a panel's width as possible. Remember the 6 mm wide expansion joint.

### C.5 EXPANSION PROFILES WITHIN THE AREA

Rooms with an uninterrupted area of 400 m<sup>2</sup> may benefit from a joint-free installation, taking into account. The minimum expansion gap of 6 mm. Do not exceed a length of approximately 20 m. Expansion profiles have to be used in rooms that are extremely long and narrow. Room areas interrupted by vertical elements (columns, walls, door frames, etc.) must be divided using expansion joints of at least 6 mm at the same level as these elements. When installing skirting boards, transition profiles or end profiles, the skirting boards or profiles must never be fixed to the floor covering. Contact your Tarkett representative if you would like more information on this.

### IMPORTANT INFORMATION ON COMPLETING THE INSTALLATION

- Remove all of the spacers.
- iD Click Ultimate must never be fixed to the subfloor, underlay, furniture or other fixtures.
- The appropriate use of anti-dirt areas and mats greatly reduces dirt deposits. Please use sliders suitable for hard floors if mobile furniture is used. Please provide office chairs and other wheeled equipment with W type castors.
- We recommend the application of a protective coat of TarkoProtect before the finished floor is used.

### PARTICULARITIES AND EXCEPTIONAL SITUATIONS

- In conservatories, verandas and winter garden behind large windows or where there is significant light exposure, we recommend to glue down iD Click Ultimate (see the list of recommended adhesives for LVT available on internet).
- Variations of temperature allowed after installation from 10°C to 60°C, keep those temperature during full life cycle of the LVT Click and minimize those temperature variations.
- Below or above, the flooring should be glued down (see the list of recommended adhesives for LVT available on internet).
- The areas close to glass window, picture window, roof window, chimney... should be glued down (see the list of recommended adhesives for LVT available on internet).
- Dyed rubber-based wheels and castors (e.g. vehicle tyres, pneumatic tyres) may cause irreversible colour changes in cases of direct interaction and contact with vinyl surfaces.

### CLEANING AND MAINTENANCE

Give the floor a final clean after installation. The floor can be maintained by sweeping, vacuuming or mopping. Use a brush and a pH-neutral detergent to remove stubborn dirt. All aggressive and staining substances must be removed from the surface immediately.

### STEP 1

Install the first panel with the tongue side facing the wall, then install all the other panels in the same way from left to right.



### STEP 2

Make sure that the ends are placed one on top of the other so that the grooves and the tongues correspond exactly and lock them by tapping lightly with a rubber mallet.

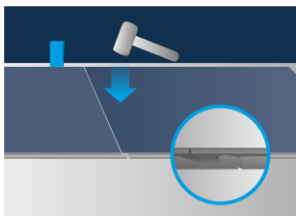

### STEP 4

Take the next panel, place it also at an angle of approximately 30° in the longitudinal direction on the panel of the first row already installed, align it as closely as possible with the end of the panel previously installed and lock it as described above.

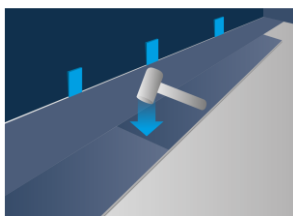
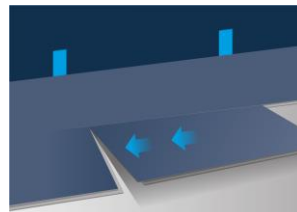

This method is then used to install all of the other rows. Make sure that the end joints are offset by at least 30 cm in the individual rows in order to achieve the best installation. To install the last row, the distance between the wall and the row installed is measured and transferred to the panel. The last row installed should be as close to half a panel's width as possible.

Remember the 6 mm wide expansion joint.

### STEP 3

To install the next row, place the left-over panel of at least 30 cm in length into the longitudinal groove of the row already installed at an angle of approximately 30° and lower it into the previous row using slight pressure.

